

FRAME					DOORS				
QUANTITY	CONST.	WIDTH	HEIGHT	JAMB DEPTH	QUANTITY	CONST.	WIDTH	HEIGHT	THICKNESS
	16 GA.			6 1/8"		16 GA.		1/2"	1 3/4"

Note: Door and frames shall be constructed of best quality galvanized sheet steel of gauges specified.

NOTES:

- 1) ASSEMBLY SHOWN IS RIGHT HAND
- 2) UNITS SHIPPED WITH ALL HARDWARE MOUNTED EXCEPT INTERLOCK
- 3) PLEASE ADVISE "HANDLING" OF LOCK ROLLER ASSEMBLY (CHECK ONE)

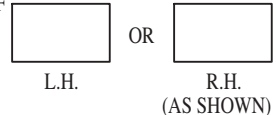

CAR SILL LINE

G.A.L. INTERLOCK TYPE- "WP"

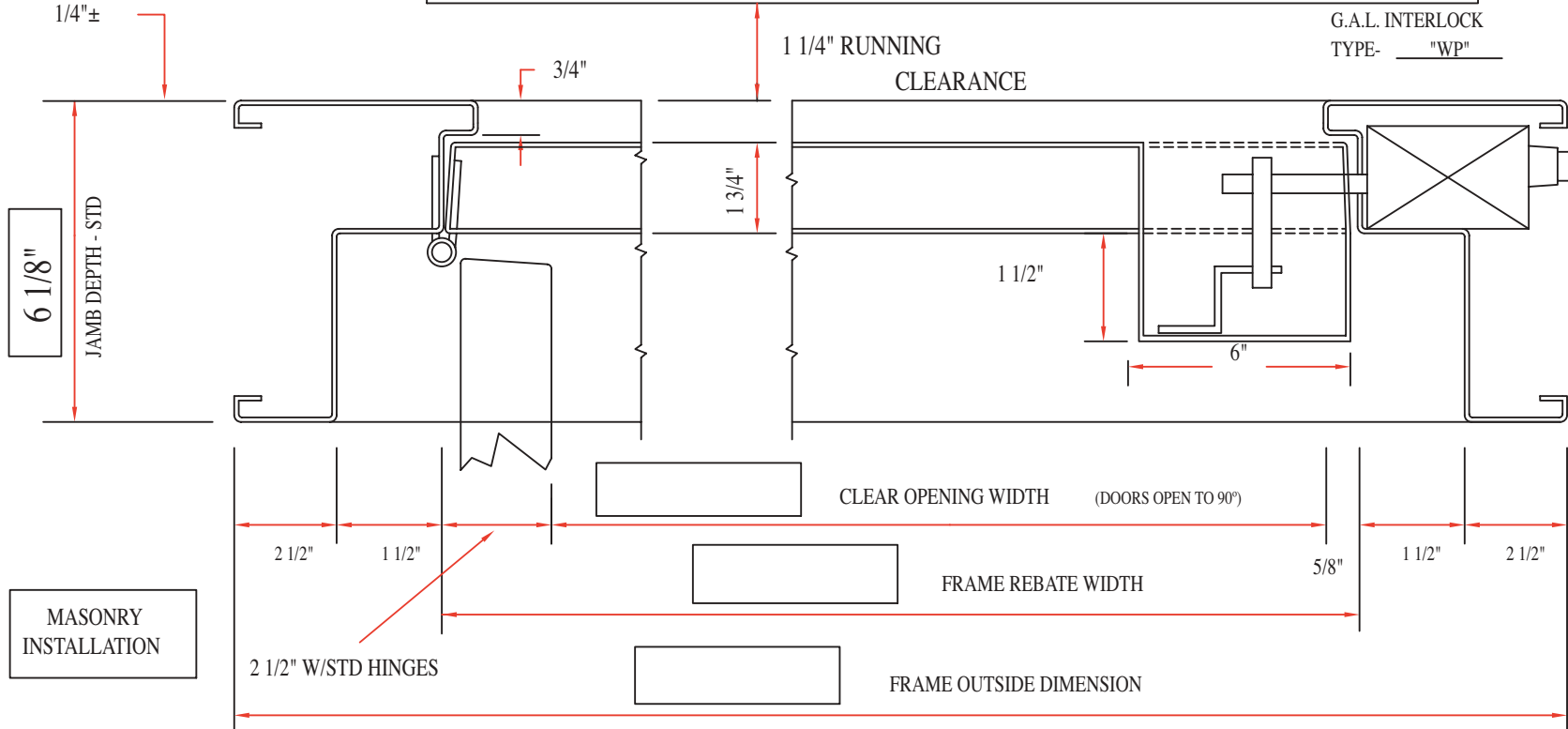
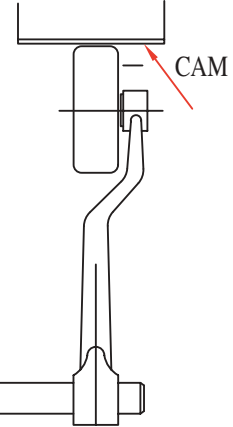

PLAN VIEW (NOT TO SCALE)

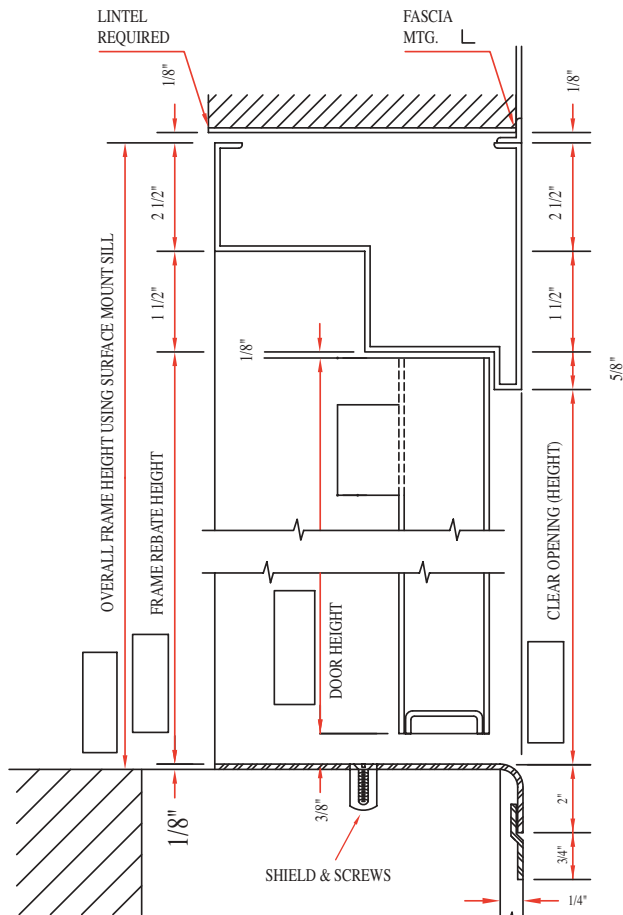

STANDARD - SURFACE MOUNT SILL

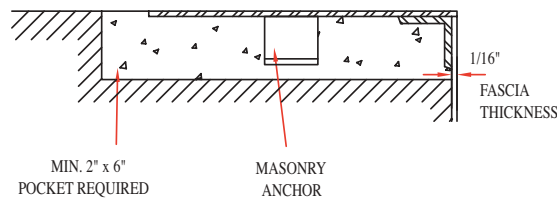

OPTIONAL - FLUSH MOUNT SILL  
VERTICAL SECTION

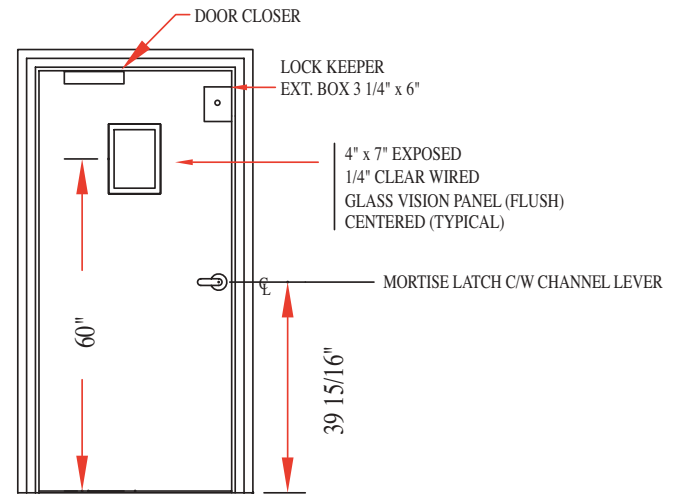

FRONT VIEW

### IMPORTANT INFORMATION NEEDED FROM INSTALLING CONTRACTOR:

Q. WHAT IS MAXIMUM ROUGH OPENING AVAILABLE? \_\_\_\_\_ WIDE x \_\_\_\_\_ HIGH  
(NOTE: PROVIDE AS MUCH ROUGH OPENING AS POSSIBLE FOR GOOD FASTENING AND SATISFACTORY INSTALLATION)

Q. WHEN ENTRANCE IS SET IN PLACE, DISTANCE FROM HATCH SIDE OF CLOSED DOOR TO CAR SILL (INCHES)?  \_\_\_\_\_

Q. (A) WILL FRAMES BE ATTACHED TO BUILDING STRUCTURE BY DRYWALL, BRICK/CONC. BLOCK? IF SO - WALL THICKNESS  \_\_\_\_\_

(B) WELDED TO STEEL CHANNELS? IF SO - SIZE OF CHANNELS  \_\_\_\_\_

(C) OTHER METHOD (SPECIFY)  \_\_\_\_\_

Q. FINISH: (A) STANDARD SATIN COAT GAL.  (B) OTHER (SPECIFY) \_\_\_\_\_

Q. WHERE IS (OR WILL BE) LOCATION OF CAM WHICH WILL UNLOCK DOOR INTERLOCKS? (VIEWED FROM LANDING)  LH  RH