

FRAME					DOORS				
QUANTITY	CONST.	WIDTH	HEIGHT	JAMB DEPTH	QUANTITY (PAIRS)	CONST.	WIDTH	HEIGHT	THICKNESS
	16 GA.					18 GA.			1 3/4"

Note: Door and frames shall be constructed of best quality galvaneal sheet steel of gauges specified.

NOTES: 1) ASSEMBLY SHOWN IS RIGHT HAND
2) PLEASE ADVISE "HANDLING" OF

(CHECK ONE)

L.H. OR R.H.
(AS SHOWN)

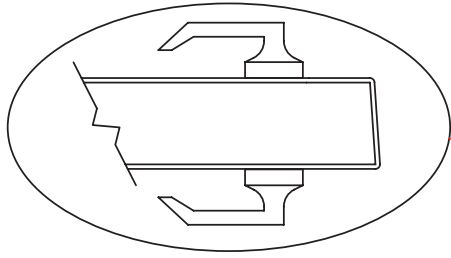

LATCH DETAIL

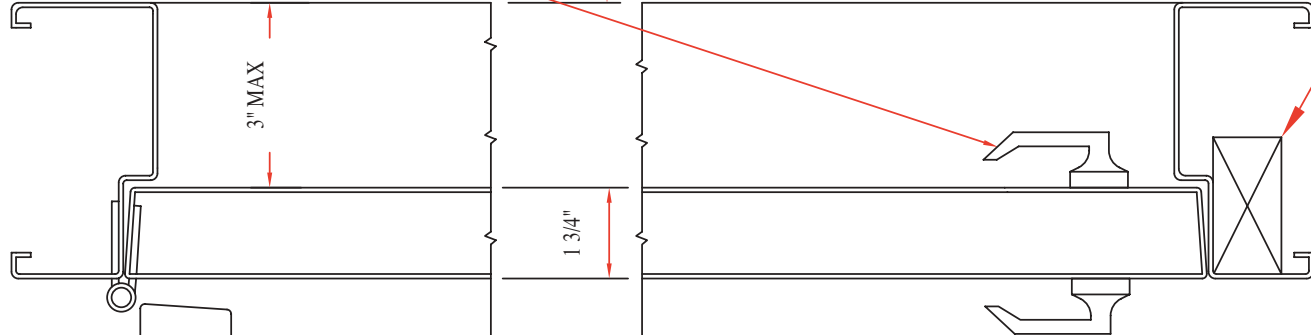
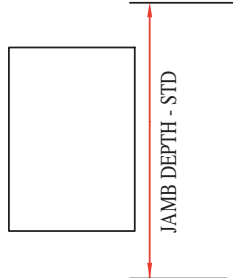
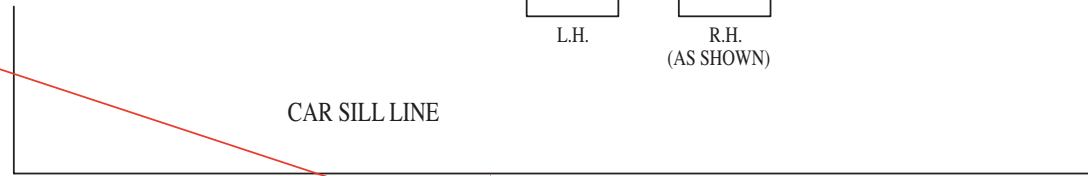

ELECTRIC STRIKE SUPPLIED BY OTHERS

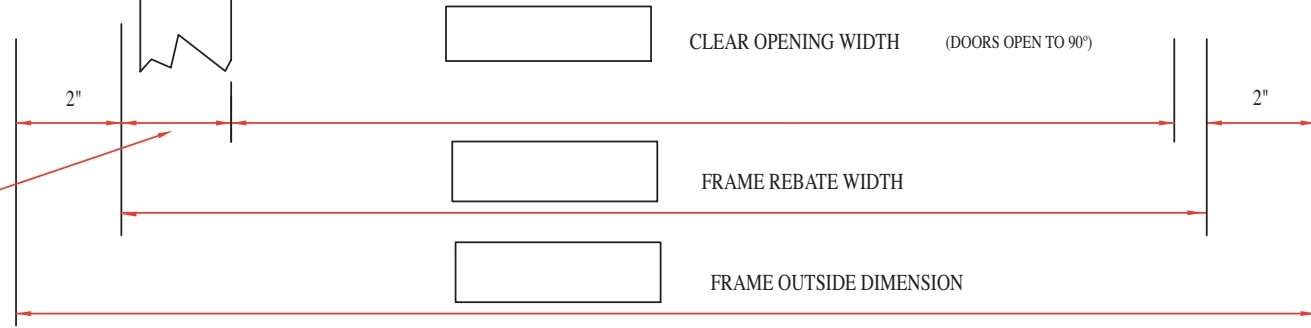

PLAN VIEW (NOT TO SCALE)

2 1/2" W/STD HINGES

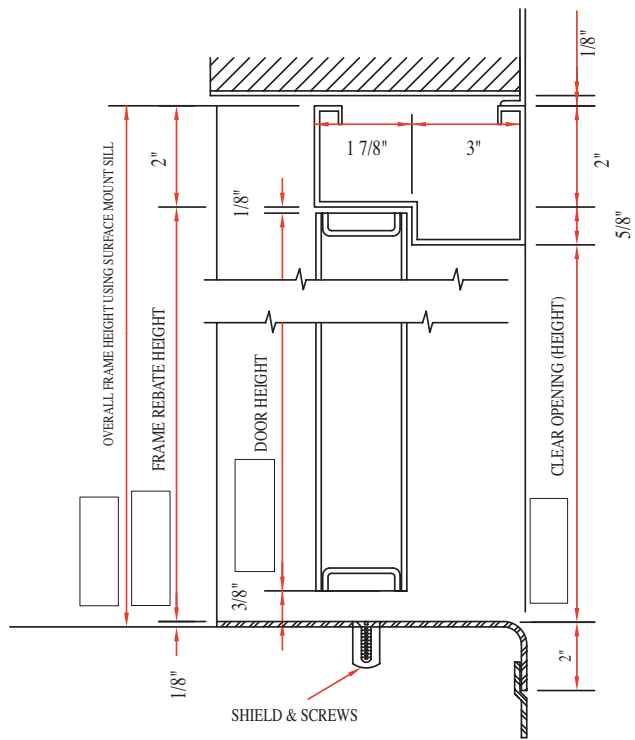

STANDARD - SURFACE MOUNT SILL

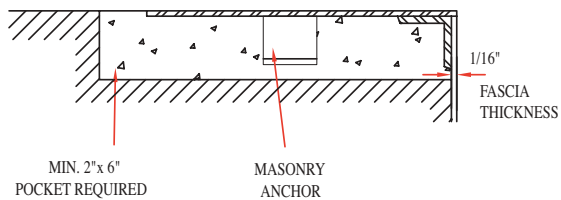

OPTIONAL - FLUSH MOUNT SILL

VERTICAL SECTION

FIRE RATED WOOD DOOR OR
6 PANEL HOLLOW METAL
DOOR (OPTIONAL)

MANY OPTION'S AVAILABLE -
ASK SALES REPRESENTATIVE

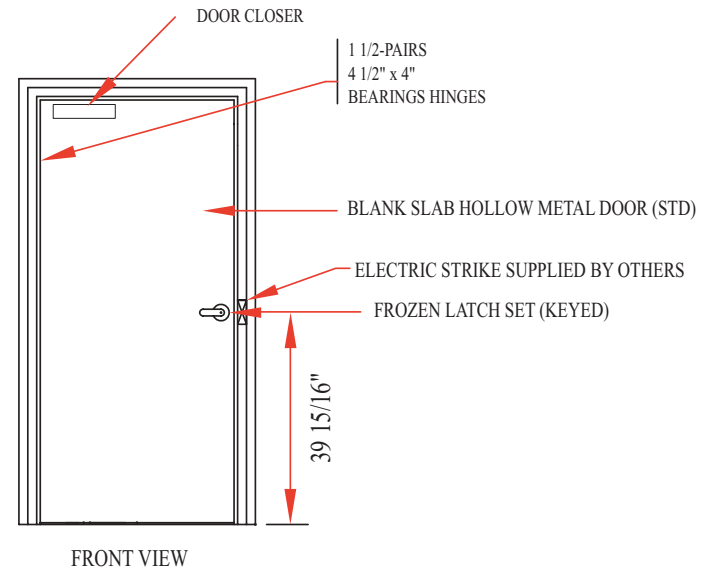

IMPORTANT INFORMATION NEEDED FROM INSTALLING CONTRACTOR:

WHAT IS MAXIMUM ROUGH OPENING AVAILABLE? _____ WIDE x _____ HIGH
(NOTE: PROVIDE AS MUCH ROUGH OPENING AS POSSIBLE FOR GOOD FASTENING AND SATISFACTORY INSTALLATION)

WHEN ENTRANCE IS SET IN PLACE, DISTANCE FROM HATCH SIDE OF CLOSED DOOR TO CAR SILL (INCHES)? _____

(A) WILL FRAMES BE ATTACHED TO BUILDING STRUCTURE BY DRYWALL, BRICK/CONC. BLOCK? IF SO - WALL THICKNESS _____

(B) WELDED TO STEEL CHANNELS? IF SO - SIZE OF CHANNELS _____

(C) OTHER METHOD (SPECIFY) _____

Q. FINISH: (A) STANDARD SATIN COAT GAL.
(B) OTHER (SPECIFY) _____

Q. SPECIFY VOLTAGE AVAILABLE FOR ELECTRIC STRIKE COIL (IF USED)

24 VAC (STANDARD) 24 VDC 12 VDC